



WORLDWIDE ELECTRIC MOTOR DATA SHEET



WWE20-18-256TCRD

HP	20	
RPM / POLES	1800 / 4	
VOLTAGE / PHASE	208-230/460 V / 3	
FRAME	256TC - ROUND BODY	
ENCLOSURE	TEFC (IP54)	
FREQUENCY	60 HZ	
RATED SPEED	1770 RPM	
FULL LOAD AMPS	52.6-47.6/23.8 A	
DUTY CYCLE	CONTINUOUS	
SERVICE FACTOR	1.15	
INSULATION CLASS	F	
AMBIENT TEMP.	40° C	
ALTITUDE	3300 FT.	
TEMP. RISE @ FULL LOAD	80° C	
DESIGN	B	
RATED TORQUE	59.7 LB. FT.	
LOCKED ROTOR TORQUE	170%	
BREAKDOWN TORQUE	260%	
LOCKED ROTOR AMPS (STARTING)	321-290/145 A	
IL / IN	6.1 / CODE G	
SLIP	1.67%	
NO LOAD CURRENT	18.6-16.8/8.4 A	
MAX. TIME LOCKED ROTOR (HOT)	20 SECONDS	
DE BEARING	6309	
ODE BEARING	6209	
REGREASING INT. - DE BEARING	9,000 HOURS (0.46 OZ.)	
REGREASING INT. - ODE BEARING	9,000 HOURS (0.29 OZ.)	
MOUNTING	F1 (F2 SUITABLE)	
ROTATION	CW / CCW	
MOMENT OF INERTIA	2.09 LB. FT. ²	
C-FLANGE	ATTACHED	
D-FLANGE	W250TD	
SHAFT MATERIAL	1045 CARBON STEEL	
CONNECTION DIAGRAM	208-230/460 V - 9 LEAD Δ	
APPROX. WEIGHT	326 LBS.	
LOAD	POWER FACTOR	EFFICIENCY
100%	0.84	91.0%
75%	0.82	90.8%
50%	0.75	90.5%





WORLDWIDE ELECTRIC MOTOR DRAWING NEMA FRAME 256TC

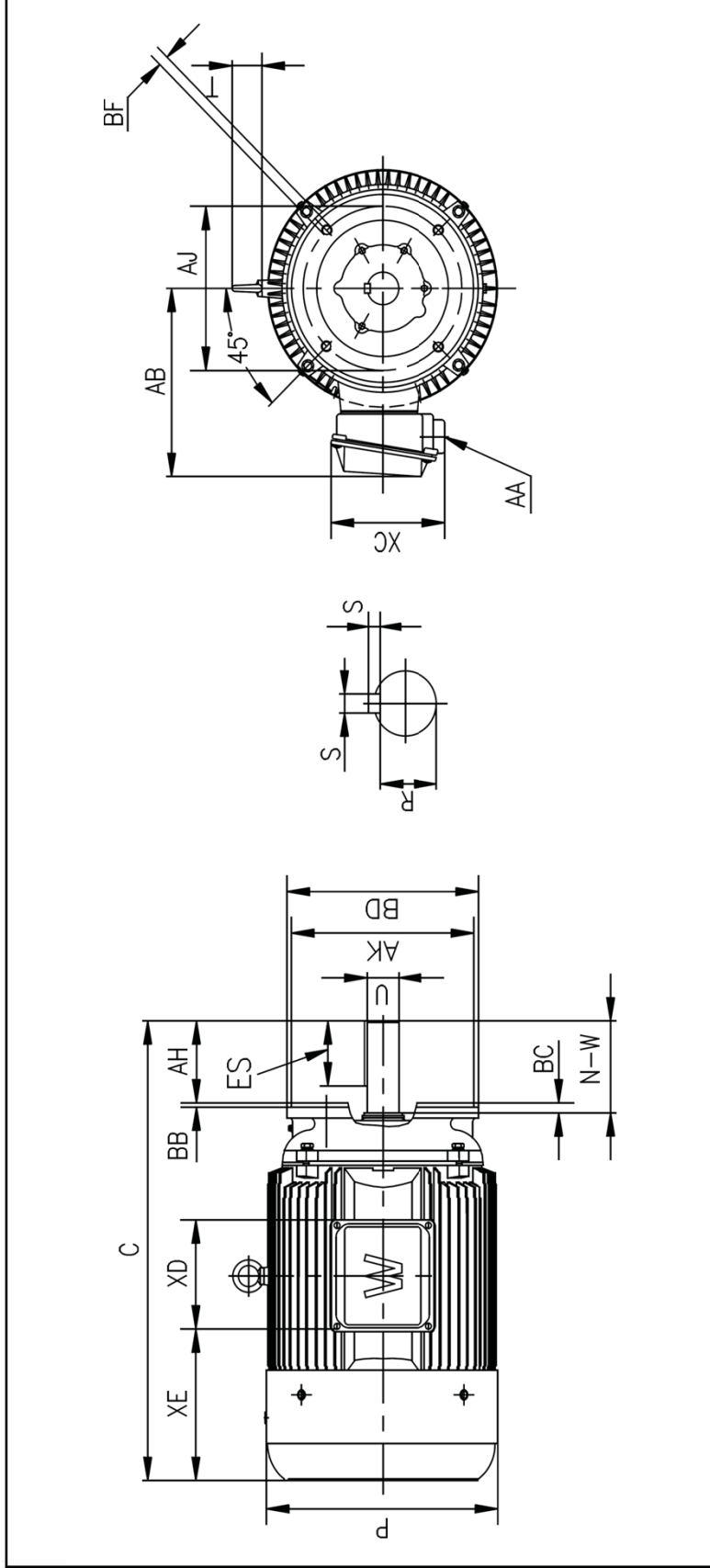

C	P	T	KEY			KEYSEAT		
			AA	AB	BC		ES	S
25.06	12.6	2.05	1.5	11.2	0.25	2.91	0.375	1.416

FLANGE			SHAFT			TERMINAL BOX			
AJ	AK	BB	BD	BF	N-W	U	XC	XD	XE
7.25	8.5	0.25	10	1/2-13	4	1.625	7.2	6.3	8.66

ALL DIMENSIONS IN INCHES